

## Site Details

Starting at a point on the northwest corner of the football field with a 16' setback going south along the existing fence. Joining the existing chain link fence at this point and going west parallel to Hanna Street for a distance of 86' to the east corner of a 60' gate opening with the west corner being at 146' from the starting point. From the west corner of 60' gate opening continue west for another 157' to a corner turning south for a distance of 275' to a corner turning east for a distance of 256' to the west corner of a 10' double gate opening with the east corner being at 266' from the east corner continue east for another 6' to connect to existing chain link fence on the southwest corner of building. Total of linear feet of fencing approximately 780' not including gate openings.

\*Dimensions are approximate and may be altered to accommodate construction or esthetics without impacting quoted price

\*\*Drawings are not to scale

\*\*\*All materials used must be galvanized or painted

### *Fence Detail*

- Fence fabric will be 11 gauge by 84" high chain link
- Post will be approximately 10' on center at a depth of 3' set in concrete
- There will be 3 strands of predator wire above top rail with 45 degree barb arms to support wire

### *Post Detail*

#### Chain link

- Terminal post will be 2 7/8 diameter steel pipe
- Line post will be 2 3/8 diameter steep pipe
- Top rail will be 1 7/8 diameter steel pipe

\*\*\* Concrete for post will be mixed with water prior to being put into post holes

### ***Gate Detail (Option 1)***

#### **Sliding Track Gate**

- Gates will be made from 2 7/8 diameter steel pipe with vertical supports at approximately 4' on center and covered with 11 gauge chain link fabric
- Gates will be approximately 32' length x 6' height with spikes along top rail

#### Track Detail for Sliding Track Gate

- Track will consist of two 60' x 6" steel I-beams with 3" diameter steel post at 4' on center set in concrete at a depth of 4'
- Track will be recessed below grade with 6" of concrete on each side with rebar

### ***Gate Detail (Option 2)***

#### **Cantilever Gate**

- Gates will be made from 2 7/8 diameter steel pipe with vertical supports at 4' on center and covered with 11 gauge chain link
- Gate sizes will be approximately 45' length x 6' height with spikes along top rail

### ***Gate Opener Detail (Option 1 & 2)***

- A Viking automatic gate opener with sufficient H.P. to operate gate of size and weight used
- Must have keypad and 5 remotes
- Must have all safety devices as specified by manufacturer and industry standards
- All wiring and conduit must be included and installed to local and N.E.C. codes

# Sliding Gate

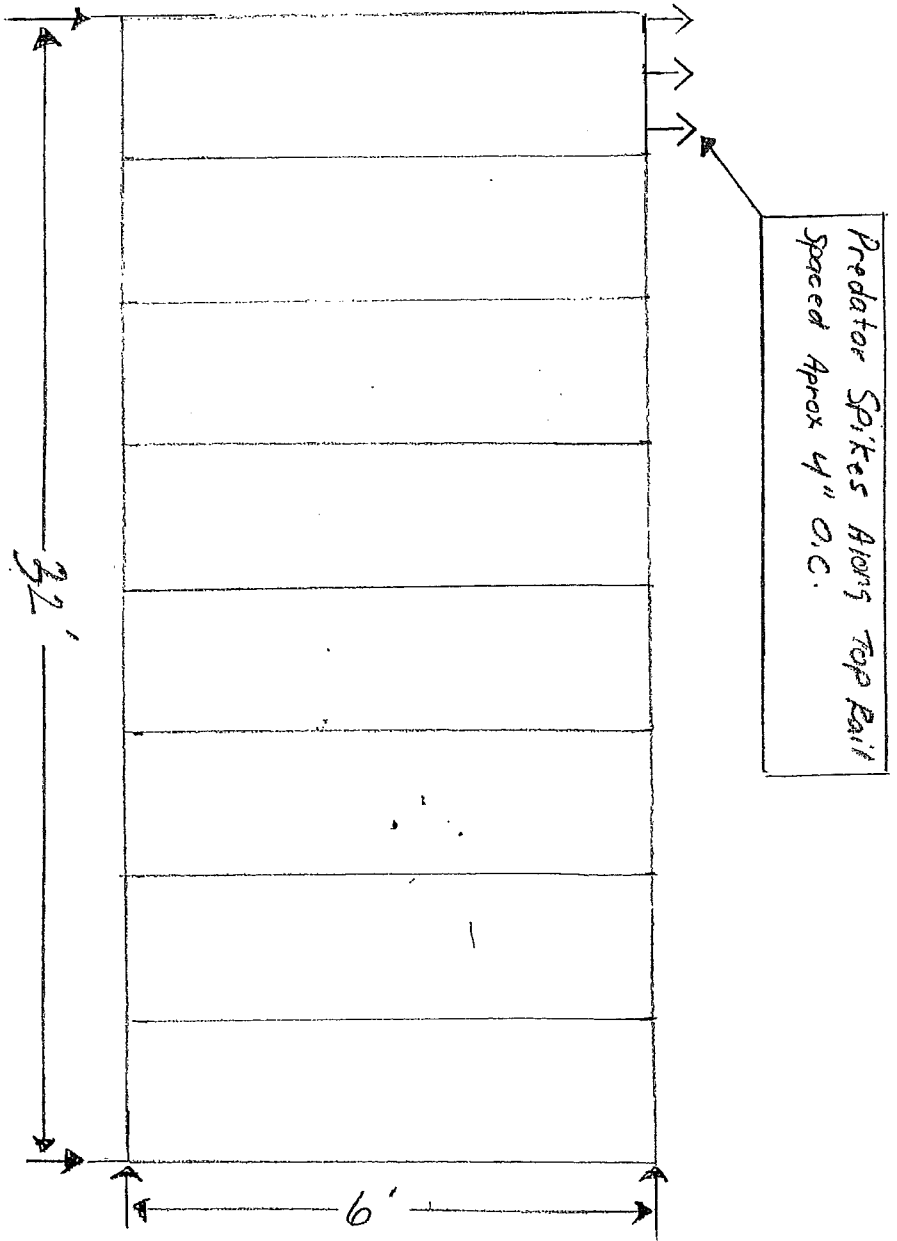

Gate Covered with 11 Gauge Fabric

ANTI LEVER Gate

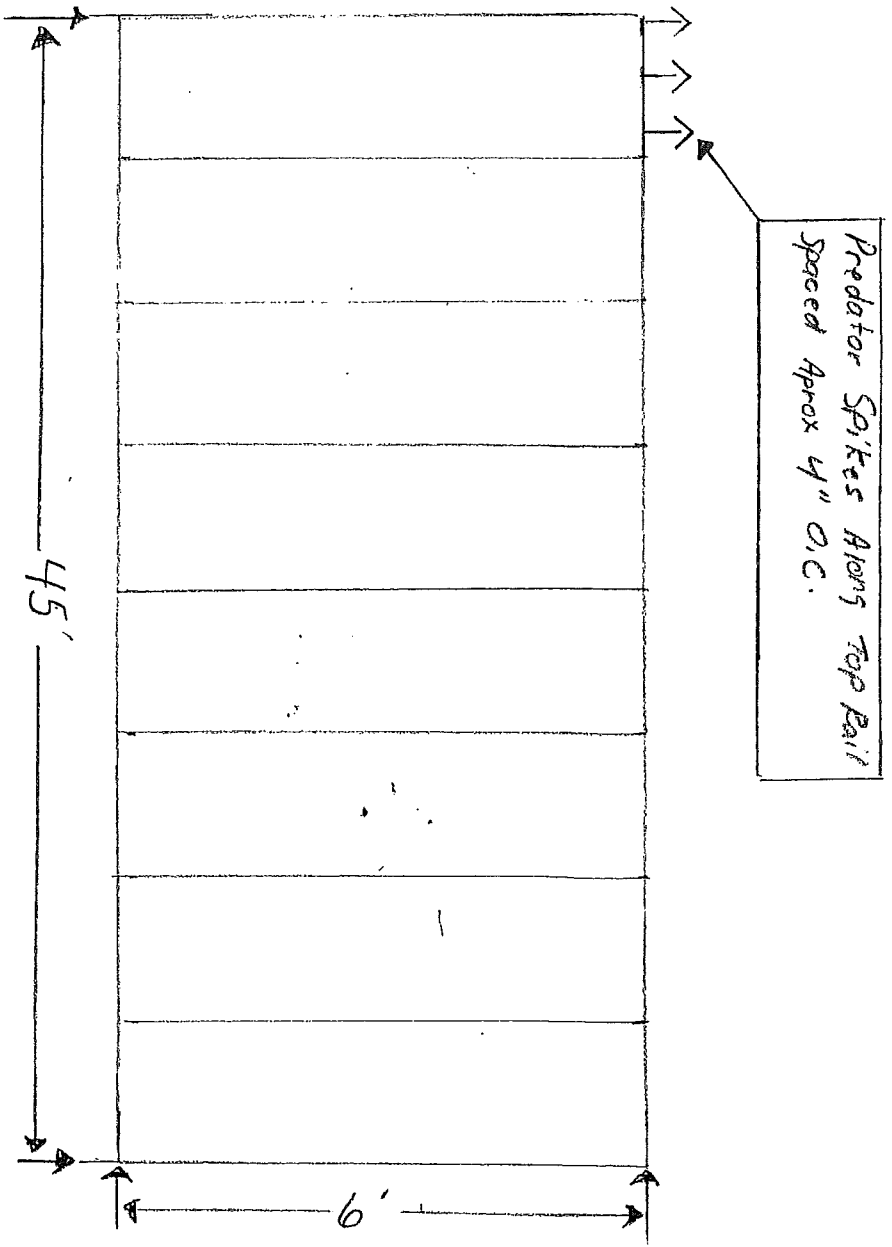

Gate Covered with 11 Gauge Fabric

End View of I-Beam Detail

120' X 6" I-Beam Detail

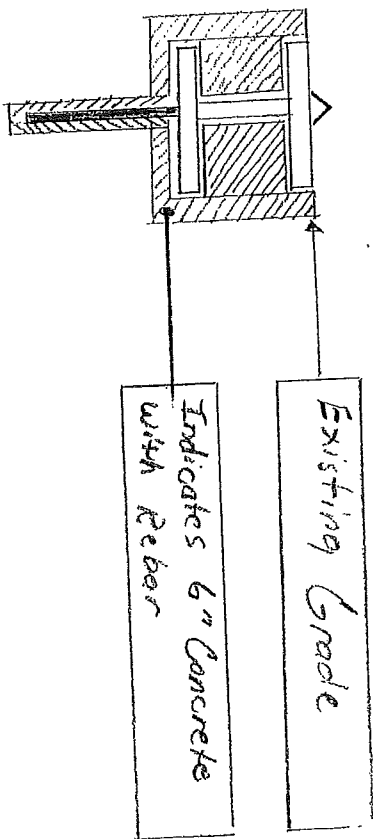

Side View

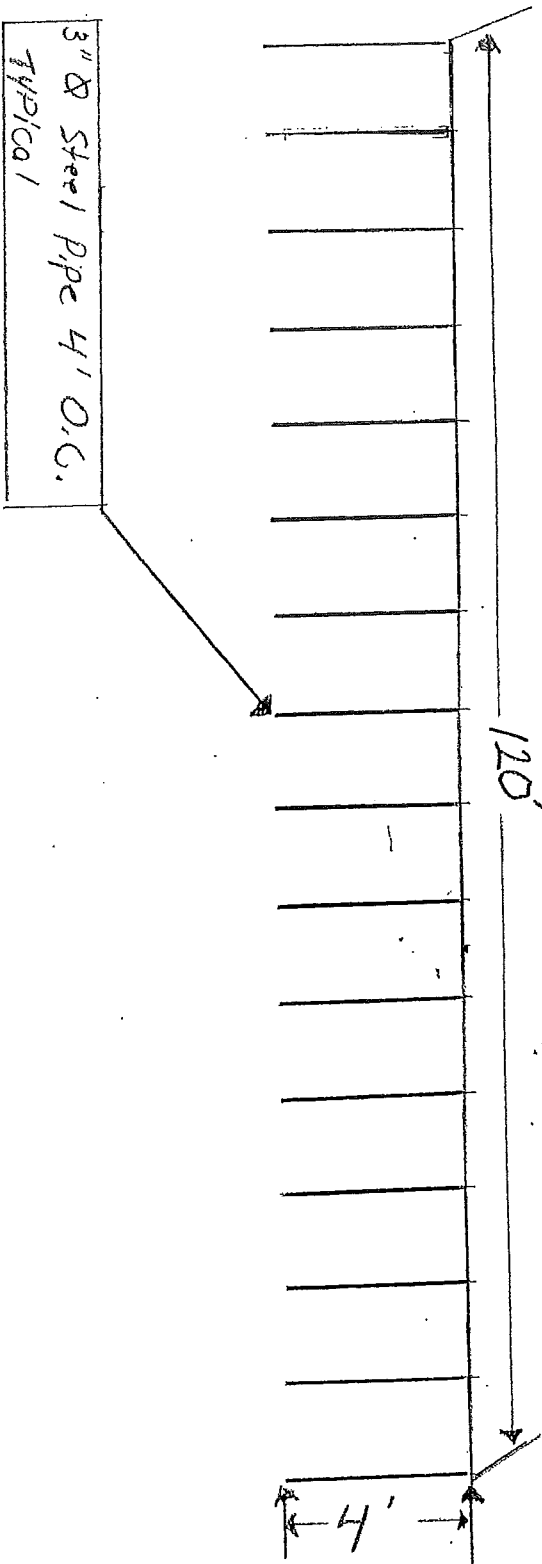

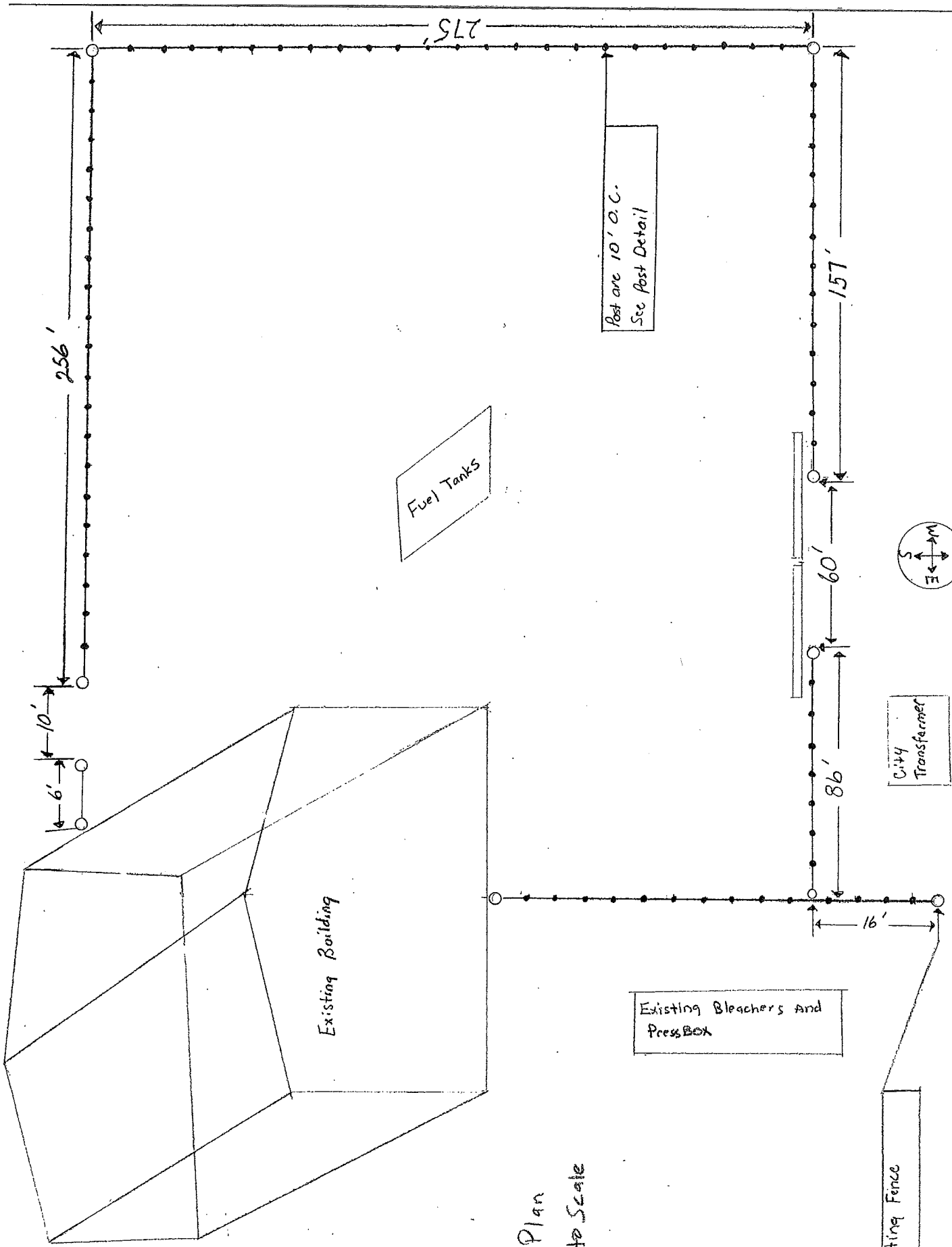

Site Plan  
Not to Scale

Post are 10' O.C.  
See Post Detail

Existing Fence

Existing Bleachers and Press Box

City Transfer

Fuel Tanks

Existing Building

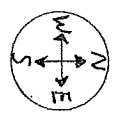

Hanna

Hanna